

INSTALLATION INSTRUCTIONS CONTINUED

Ensure the bracket is installed with the prongs (where the weights will be supported) angled upwards and the Les Mills logo at the bottom (as per the image to the right).

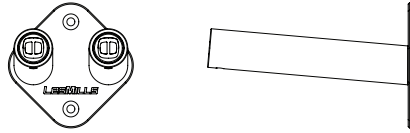

The supplied wall plugs are suitable for standard concrete and brick walls. For other wall types, special wall plugs must be used. Please consult a construction professional for advice.

Prior to assembly, remove all components from the packaging and check against the parts list on the previous page.

PLASTERBOARD / DRYWALL INSTALLATION (for walls with existing studs)

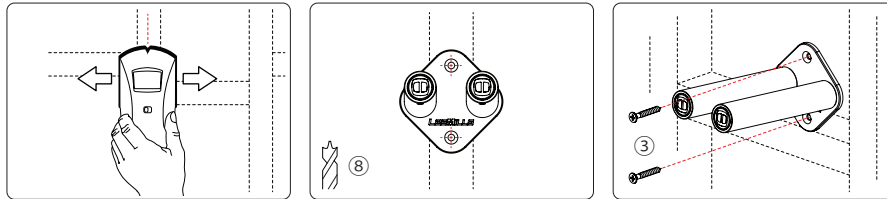

STEP 1 Use a stud finder to locate and mark the location of the existing studs in the wall.

STEP 2 Position the WALL STORAGE bracket ① in the desired location and mark the center of the top and bottom holes over the stud.

Drill 5/32" (4mm) pilot holes into the stud at each marked location.

STEP 3 Using the supplied 45mm long screws ③, install the WALL STORAGE bracket ① to the wall and tighten until the head of the screw sits flush with the face of the bracket.

FOR CONCRETE / BRICK WALL INSTALLATION

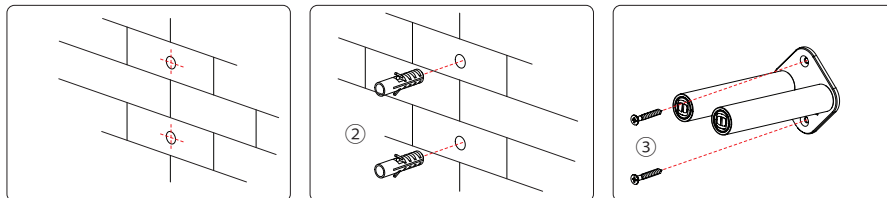

STEP 1 Position the WALL STORAGE brackets ① in the desired location and mark the center of the top and bottom holes.

Drill 25/64" (10mm) pilot holes at each marked location.

STEP 2 Install the supplied wall expansion anchors ② into the 25/64" (10mm) holes until they sit flush with the wall.

STEP 3 Using the supplied 45mm long screws ③, install the WALL STORAGE bracket ① to the wall and tighten until the head of the screw sits flush with the face of the bracket.

Ensure the WALL STORAGE bracket is securely anchored, without any movement before use. We recommend testing the product by initially placing one weight onto the WALL STORAGE at a time.

For warranty information visit: <https://www.lesmills.com/merchandise/equipment/warranty/>

LES MILLS SMARTBAR

WALL STORAGE

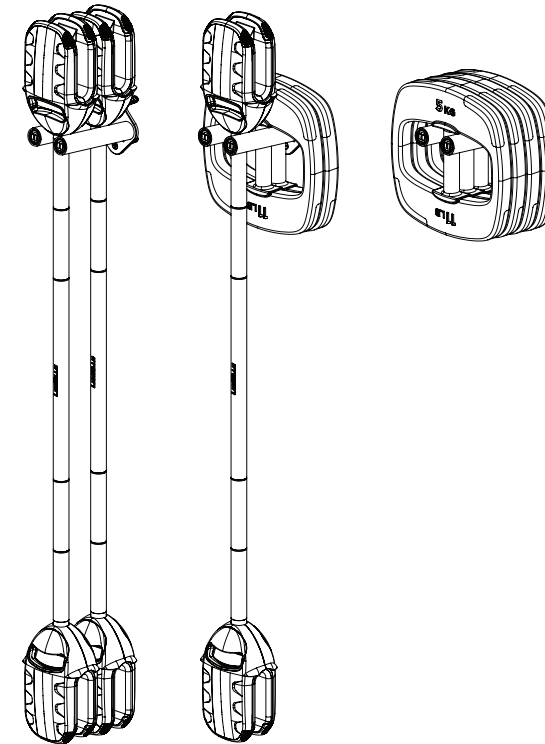

ASSEMBLY & USER INSTRUCTIONS
PLEASE KEEP FOR FUTURE REFERENCE

D2CRCKWS-C

SMARTBAR™ WALL STORAGE

IMPORTANT: READ ALL INSTRUCTIONS CAREFULLY BEFORE INSTALLING THIS PRODUCT. PLEASE KEEP INSTRUCTIONS FOR FUTURE REFERENCE.

The Les Mills WALL STORAGE has been specifically designed for storing Les Mills equipment only.

It can store up to four Weight Plates or two SMARTBAR™. Alternatively, a combination of two Weight Plates and one SMARTBAR. **Due to space restrictions, this number of Weight Plates and SMARTBAR should never be exceeded, even if the maximum weight detailed below is not met.**

The maximum capacity per WALL STORAGE bracket is 40KG / 88LB. By way of example, the WALL STORAGE can store four Les Mills Weight Plates (weighing up to 10KG each), or two Les Mills Weight Plates (weighing up to 10KG each) and one SMARTBAR, or two SMARTBARS.

SAFETY INFORMATION



WARNING: FAILURE TO ADHERE TO THESE INSTRUCTIONS COULD RESULT IN SERIOUS INJURY OR DEATH.



CHOKING HAZARD: SMALL PARTS IN THE INSTALLATION KIT COULD PRESENT A CHOKING HAZARD.



NEVER EXCEED THE NUMBER OF WEIGHT PLATES AND SMARTBAR SPECIFIED EVEN IF THE MAXIMUM WEIGHT IS NOT MET.

- This WALL STORAGE is not a toy and should only be used by those aged 14 years or older.
- The owner of this WALL STORAGE is responsible for ensuring that all users of this product are adequately informed of all the safety information.
- Only use this WALL STORAGE as a storage facility for specified Les Mills equipment.
- This WALL STORAGE is only intended for personal domestic use.
- Do not place any additional load on the WALL STORAGE other than what it has been designed to accommodate. Overloading may impair stability and lead to equipment falling off, potentially causing serious injury or even death.
- Choose a mounting location in a clearly accessible area with a flat, stable and level surface to lift the weights from, free from other obstructions such as slanted ceilings, and within easy reach of the user.
- Keep children away to prevent injury from climbing or hanging on the WALL STORAGE. Children could get seriously injured by falling equipment or by fall off the WALL STORAGE themselves.
- Never leave children unsupervised with the WALL STORAGE.
- After assembling the WALL STORAGE, and before each use, carefully inspect to ensure there is no damage and the screws are tight.
- The WALL STORAGE must not be modified.

CARE & MAINTENANCE

- After assembling the WALL STORAGE, and before each use, carefully inspect to ensure there is no damage and the screws are tight. Stop use of the WALL STORAGE immediately if there are any signs of damage.
- For cleaning, please wipe the WALL STORAGE with a clean, damp cloth with mild detergent. Please then dry with a clean, dry cloth.
- Keep the WALL STORAGE indoors and away from any moisture and dust.
- Do not attempt to repair the WALL STORAGE yourself.
- If you have any difficulties with the assembly or the use of this WALL STORAGE, or if you think that any parts are missing, please get in touch with your local Les Mills authorised equipment distributor.
- If you no longer want your WALL STORAGE, please dispose responsibly, in accordance with local household recycling guidelines.

PARTS INCLUDED

The Les Mills WALL STORAGE comprises of the following components:

- ① 2x WALL STORAGE brackets
- ② 4x Wall expansion anchors
- ③ 4x 45mm long screws

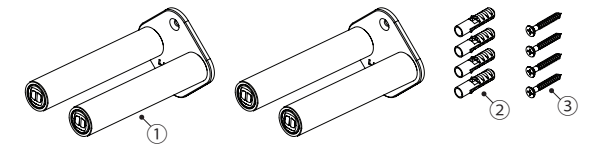

You will also need the following tools:

- ④ Pencil
- ⑤ Stud Finder
- ⑥ Philips Screwdriver
- ⑦ Power Drill
- ⑧ Ø 5/32" (4mm) wood drill (for plasterboard/wood walls)
- ⑨ Ø 25/64" (10mm) concrete/brick drill (for concrete/brick walls)

INSTALLATION INSTRUCTIONS

Prior to assembly, remove all components from the packaging and check against the parts list on the previous page. If any parts are missing or you notice any sign of damage please return the WALL STORAGE to your local authorised equipment distributor. Please ensure that no equipment is placed on the WALL STORAGE bracket during assembly.

The WALL STORAGE bracket has been designed to be installed onto a plasterboard wall with a wooden stud, or a concrete/brick wall. Wall structures vary. **Please consult a construction professional to confirm whether your wall structure is appropriate for installation of this WALL STORAGE bracket.**